

# Modular School - Ross Montessori School

## Modular school buildings: Occupy 50% sooner and save up to 40% of cost vs "stick-built" construction

This 15-plex modular school was designed for the Ross Montessori School. In a mere 19 days, Pac-Van was able to deliver and install over 11,376 square feet of building space allowing the school to open on time. The innovative "H" design has 8 classrooms that each attach to the school's central 1500 sf common area. Each classroom has 1080 sf with (2) 4x4 windows, an exterior door, and is covered in 2/3 carpet & 1/3 tile. Ten rooftop HVAC units were installed to allow for separate zones for each classroom.

Although this was intended to be a permanent building, the design does allow for the building to be broken up into (5) 3-plex units, should the need arise. This flexibility is one of the main advantages of Pac-Van modular buildings!

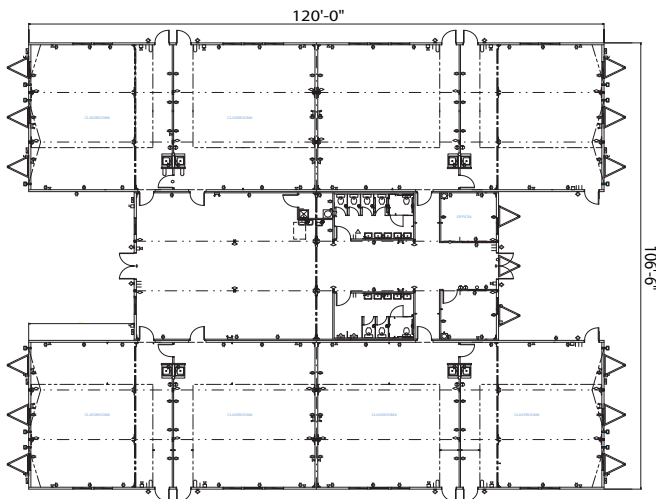
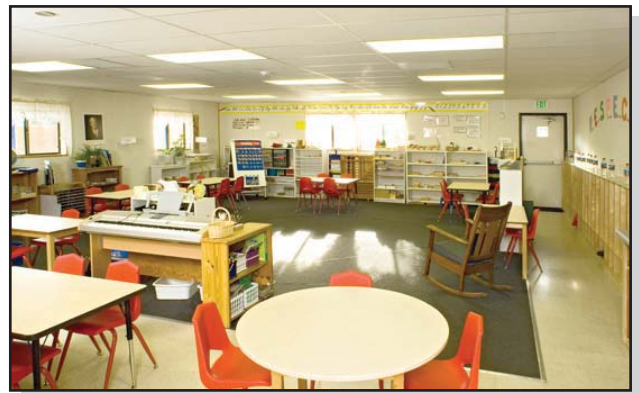

### Experience You Can Trust - Quality You Demand

When time is of the essence, the quick construction time of modular buildings make them ideal for temporary or permanent educational applications. Pac-Van offers flexible lease or purchase plans. Learn more about modular buildings at:  
[www.pacvan.com/modular-buildings](http://www.pacvan.com/modular-buildings)

**Nationwide 800.586.1295**

**We've put thousands of U.S. businesses in space™  
Modular Buildings - Mobile Offices - Storage Equipment**

**Pac-Van™**