

Modular Classrooms



Lamb Of God Lutheran School

Building Specifications:

- 4 - 14' x 73'
- 2 - 14' x 46'
- 2 - 14' x 50'
- 6,776 total square feet

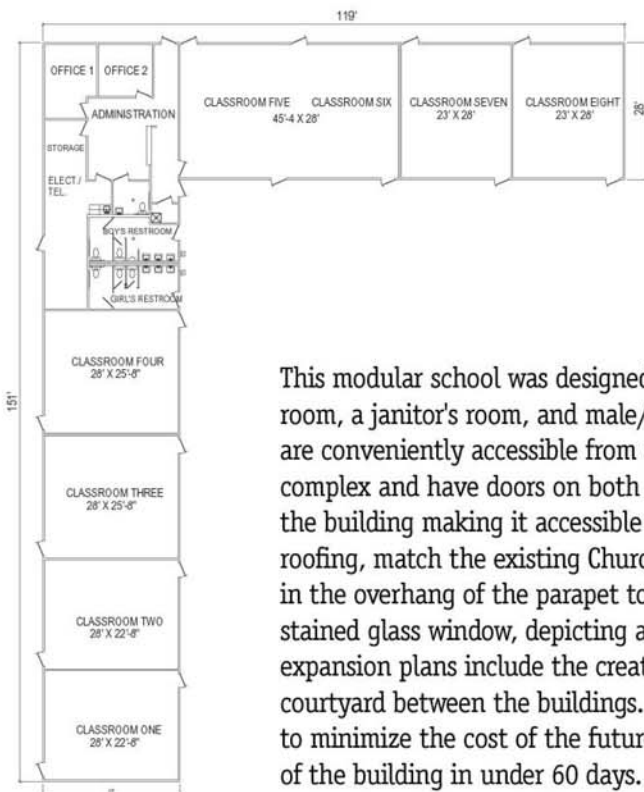

This modular school was designed with expansion in mind. Administrative offices, a storage room, a janitor's room, and male/female restrooms are all located at the corner of the "L" and are conveniently accessible from all classrooms. The classrooms extend out to each end of the complex and have doors on both the front and back of each room. A system of sidewalks surround the building making it accessible from all sides. The parapet, created from trusses clad with tile roofing, match the existing Church building adjacent to the school. Wall wash lighting is located in the overhang of the parapet to accentuate the succoed exterior of the building. A round stained glass window, depicting a Lamb and Shepherd, graces the principal's office. The future expansion plans include the creation of a matching "L-shaped" structure that will create a courtyard between the buildings. Electrical, sprinkler, alarm, and plumbing feeds were planned to minimize the cost of the future expansion. All this, and the customer still took possession of the building in under 60 days.

Experience You Can Trust - Quality You Demand

When time is of the essence, the quick construction time of modular buildings make them ideal for school expansions. Pac-Van modular buildings are built from the same durable materials as traditional construction and meet all prevailing state and local codes.



www.pacvan.com

Nationwide **800.586.1295**