

Special Application - Gahanna HS Press Box

Pac-Van custom-built modular press box adds to the view both on and off the field!

This 900 sq. ft. modular press box was constructed to add more seating and create an enhanced viewing experience. The two piece building is 90 feet long overall and 10 feet wide offering a main control box, two coach's boxes, and a suite on each end. The wood-trimmed 60x48" windows allow for extraordinary viewing of any sporting event and are slanted at a slight angle to prevent any glare. There is roof access for camera crews to tape events surrounded by a 10x20' railing. The box was placed just behind the bleachers 35' off the ground on a steel structure. Built-in counter tops offer ease and comfort in sports reporting.

Two cranes were used to lift each module to its specific location. During placement, the buildings were welded on several points. All engineering was planned to keep weight to a minimum including the decision to use aluminum siding. The deadline for this project was very strict because the building and all items associated with this project had to be installed before the first scheduled event. Using modular construction offered the school district the time and budget savings to accommodate their space needs.

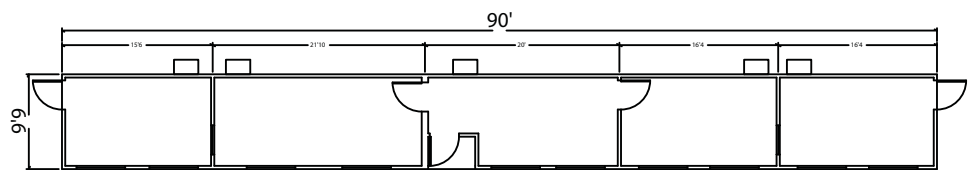

Experience You Can Trust - Quality You Demand

When time and budget are of the essence, the flexibility of modular construction is ideal for specialized applications. Pac-Van offers flexible lease and purchase plans. Learn more about modular buildings at:

www.pacvan.com/modular-school.aspx

Nationwide **800.587.1784**

We've put thousands of U.S. businesses in space™
Modular Buildings - Mobile Offices - Storage Equipment

